



LEPUS Heavy Duty

Listed to
ANSI/UL 325

**IRREVERSIBLE MOTOR-REDUCER MONOPHASES FOR SLIDING GATES.HEAVY DUTY CYCLES.
MAX WEIGHT GATE: 1200 Pound**

Compact, Powerful and Silent

The Lepus is a motor-reducer for sliding gates with a mechanical bidisk clutch for a sensitive regulation of the motor torque, inversion during the closing cycle when it meets an obstacle, available with chain or rack and pinion.

The perfect keeping of the system in closing is granted by the irreversibility of the gear wheel tangent screw. The electric motor, friction clutch and reduction gears are housed in a single-piece cast aluminium block and **constantly immersed in an oil bath**. The oil bath acts as both the lubricant for the gears and as a cooling agent to dissipate the heat generated by the electric motor during operation.

Limit Switch

Lepus Chain Box is equipped with an internal limit switch (very easy adjusting)

Lepus Rack/Chain (small case) is equipped with a mechanical limit switch.

Manual Release

In case of power failure, the unit can be mechanically released using a special key and the gate or door operated manually until power is restored

Lepus Chain Box



Manual release

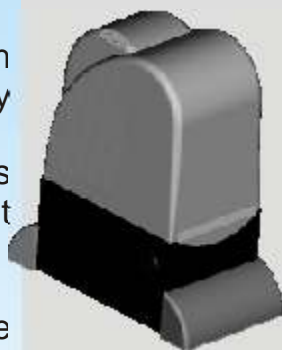

Lepus rack

OPERATOR SPECIFICATION

Motor	Monophase
Supply voltage	115 Vac \pm 5%
Motor current	3,2A
Motor revol. Speed	1700 rpm
Operating temperature	-43°F +131°F
Thermal protection on the motor winding	266°F
Weight with oil	62 Pound
Oil quantity	0,46 Gal
Opening gate speed	8 - 11 Inc / sec
Protection class	IP 44
Max gate weight	1200 Pound

DESCRIPTION	COD	Max Gate Weight Pound	Power Supply
LEPUS Chain Box	1110MEC0BOX-08	1200	115
LEPUS Rack	1110ELR0FL-08	1200	115
LEPUS Chain with Small Case	1110MEC0GPK-08	1200	115





**SLIDE PRO Control Board
for LEPUS series**

Cod. 2300A110SU



LEPUS Series

ACCESSORIES FOR INSTALLATION

DESCRIPTION	COD		DESCRIPTION	COD	
MOUNTING PLATE	16200065		ZINC GEAR RACK MOD 4 (3.28 feet) WITH ACCESSORIES	12715010	
PINION Z 20 / Z 27 FOR GEAR RACK	Call SEA USA		PINION GROUP FOR CHAIN	12710040	



Typical Installation

- 1) LEPUS Motor
- 2) Photocell Sx
- 3) Photocell Dx
- 4) Pneumatic safety edge
- 5) Pneumatic switch
- 6) Warning light
- 7) Radio receiver
- 8) Antenna
- 9) Warning plate
- 10) Control unit
- 11) Differential 16A - 30mA

